

Register your product and get support at  
[www.philips.com/welcome](http://www.philips.com/welcome)

**GoGear**

SA028302  
SA028304  
SA028308



EN User manual

---

**PHILIPS**



# Contents

<b>1 Important safety information</b>	<b>4</b>
General maintenance	4
Recycling the product	7
<b>2 Your new SA028</b>	<b>8</b>
What's in the box	8
Software loaded on the SA028	8
Files loaded on the SA028	8
Overview	9
Controls and connections	9
Home screen (main menu)	10
<b>3 Getting started</b>	<b>11</b>
Connect SA028 to a computer	11
First-time setup	11
Charge power	11
Turn SA028 on and off	12
Automatic standby and shut-down	12
Connect earphones	12
Limit the volume	12
<b>4 Music</b>	<b>13</b>
Manage music on PC	13
Transfer music to SA028	13
Add or delete music files	13
Find your music	14
Fast scroll	14
Play music	14
<b>5 FM radio</b>	<b>15</b>
Tune to radio stations	15
Store preset stations	15
Listen to FM radio	15
<b>6 Recordings</b>	<b>16</b>
Record audio/voices	16
Listen to recordings	16
Delete one or more recordings	16
Upload your recordings to a computer	16

<b>7 Settings</b>	<b>17</b>
Play mode	17
Sound settings	17
Display settings	17
Screen off timer	17
Screensaver	18
Language	18
Information	18
Restore factory settings	18
<b>8 Update SA028</b>	<b>19</b>
Manually verify / update firmware	19
<b>9 Troubleshooting</b>	<b>20</b>
<b>10 Technical data</b>	<b>21</b>
System requirements	21

## Need help?

Please visit

[www.philips.com/welcome](http://www.philips.com/welcome)

where you can access a full set of supporting materials such as the user manual, the latest software updates, and answers to frequently asked questions.

# 1 Important safety information

## General maintenance

The translation of this document is for reference only.

In the event of any inconsistency between the English version and the translated version, the English version shall prevail.

### Caution

- To avoid damage or malfunction:
- Do not expose the product to excessive heat caused by heating equipment or direct sunlight.
- Do not drop the product or allow objects to fall on your player.
- Do not allow the product to be submerged in water. Do not expose headphone socket or battery compartment to water, as water entering the set may cause major damage.
- Active mobile phones in the vicinity may cause interference.
- Back up your files. Ensure that you retain the original files you have downloaded to your device. Philips is not responsible for any loss of data if the product becomes damaged or not readable / legible.
- Manage (transfer, delete, etc.) your music files only with the supplied music software to avoid problems.
- Do not use any cleaning agents containing alcohol, ammonia, benzene, or abrasives as these may harm the product.

### About operating and storage temperatures

- Operate in a place where temperature is always between 0 and 35°C (32 to 95°F)
- Store in a place where temperature is always between -20 and 45°C (-4 to 113°F).
- Battery life may be shortened in low temperature conditions.

### Replacement parts/accessories:

Visit [www.philips.com/support](http://www.philips.com/support) to order replacement parts/accessories.

### Hearing Safety



#### Listen at a moderate volume:

Using headphones at a high volume can impair your hearing. This product can produce sounds in decibel ranges that may cause hearing loss for a normal person, even for exposure less than a minute. The higher decibel ranges are offered for those that may have already experienced some hearing loss.

Sound can be deceiving. Over time your hearing 'comfort level' adapts to higher volumes of sound. So after prolonged listening, what sounds 'normal' can actually be loud and harmful to your hearing. To guard against this, set your volume to a safe level before your hearing adapts and leave it there.

To establish a safe volume level:

Set your volume control at a low setting.

Slowly increase the sound until you can hear it comfortably and clearly, without distortion.

Listen for reasonable periods of time:

Prolonged exposure to sound, even at normally 'safe' levels, can also cause hearing loss.

Be sure to use your equipment reasonably and take appropriate breaks.

Be sure to observe the following guidelines when using your headphones.

Listen at reasonable volumes for reasonable periods of time.

Be careful not to adjust the volume as your hearing adapts.

Do not turn up the volume so high that you can't hear what's around you.

You should use caution or temporarily discontinue use in potentially hazardous situations.

Do not use headphones while operating a motorized vehicle, cycling, skateboarding, etc.; it may create a traffic hazard and is illegal in many areas.

## Modifications

Modifications not authorized by the manufacturer may void user's authority to operate the product.

## Copyright information

All other brands and product names are trademarks of their respective companies or organizations.

Unauthorized duplication of any recordings whether downloaded from the Internet or made from audio CDs is a violation of copyright laws and international treaties.

The making of unauthorized copies of copy-protected material, including computer programs, files, broadcasts and sound recordings, may be an infringement of copyrights and constitute a criminal offense. This equipment should not be used for such purposes.

The Windows Media and the Windows logo are registered trademarks of Microsoft Corporation in the United States and/or other countries.

**Be responsible! Respect copyrights.**



**Be responsible  
Respect copyrights**

Philips respects the intellectual property of others, and we ask our users to do the same.

Multimedia content on the internet may have been created and/or distributed without the original copyright owner's authorization.

Copying or distributing unauthorized content may violate copyright laws in various countries including yours.

Compliance with copyright laws remains your responsibility.

The recording and transfer to the portable player of video streams downloaded to your computer is intended only for use with public domain or properly licensed content. You may only use such content for your private, non-commercial use and shall respect eventual copyright instructions provided by the copyright owner of the work. Such instruction may state that no further copies shall be made. Video streams may include copy protection technology that prohibits further copying. For such situations the recording function will not work and you will be notified with a message.

## Data logging

Philips is committed to improving the quality of your product and enhancing the Philips user experience. To understand the usage profile of this device, this device logs some info / data to the non-volatile memory region of the device. These data are used to identify and detect any failures or problems you as a user may experience while using the device. The data stored, for example, will be the duration of playback in music mode, duration of playback in turner mode, how many times battery low was encountered, etc. The data stored do not reveal the content or media used on the device or the source of downloads. The data stored on the device are retrieved and used **ONLY** if the user returns the device to the Philips service center and **ONLY** to simplify error detection and prevention. The data stored shall be made available to user on user's first request.

## Monkey's Audio decoder

- ① The Monkey's Audio SDK and source code can be freely used to add APE format playback, encoding, or tagging support to any product, free or commercial. Use of the code for proprietary efforts that don't support the official APE format require written consent of the author.
- ② Monkey's Audio source can be included in GPL and open-source software, although Monkey's Audio itself will not be subjected to external licensing requirements or other viral source restrictions.
- ③ Code changes and improvements must be contributed back to the Monkey's Audio project free from restrictions or royalties, unless exempted by express written consent of the author.
- ④ Any source code, ideas, or libraries used must be plainly acknowledged in the software using the code.
- ⑤ Although the software has been tested thoroughly, the author is in no way responsible for damages due to bugs or misuse.

If you do not completely agree with all of the previous stipulations, you must cease using this source code and remove it from your storage device.

## FLAC decoder

Copyright (C) 2000,2001,2002,2003,2004,2005, 2006,2007,2008,2009 Josh Coalson

Redistribution and use in source and binary forms, with or without modification, are permitted provided that the following conditions are met:

- Redistributions of source code must retain the above copyright notice, this list of conditions and the following disclaimer.
- Redistributions in binary form must reproduce the above copyright notice, this list of conditions and the following disclaimer in the documentation and/or other materials provided with the distribution.
- Neither the name of the Xiph.org Foundation nor the names of its contributors may be used to endorse or promote products derived from this software without specific prior written permission.

THIS SOFTWARE IS PROVIDED BY THE COPYRIGHT HOLDERS AND CONTRIBUTORS "AS IS" AND ANY EXPRESS OR IMPLIED WARRANTIES, INCLUDING, BUT NOT LIMITED TO, THE IMPLIED WARRANTIES OF MERCHANTABILITY AND FITNESS FOR A PARTICULAR PURPOSE ARE DISCLAIMED. IN NO EVENT SHALL THE FOUNDATION OR CONTRIBUTORS BE LIABLE FOR ANY DIRECT, INDIRECT, INCIDENTAL, SPECIAL, EXEMPLARY, OR CONSEQUENTIAL DAMAGES (INCLUDING, BUT NOT LIMITED TO, PROCUREMENT OF SUBSTITUTE GOODS OR SERVICES; LOSS OF USE, DATA, OR PROFITS; OR BUSINESS INTERRUPTION) HOWEVER CAUSED AND ON ANY THEORY OF LIABILITY, WHETHER IN CONTRACT, STRICT LIABILITY, OR TORT (INCLUDING NEGLIGENCE OR OTHERWISE) ARISING IN ANY WAY OUT OF THE USE OF THIS SOFTWARE, EVEN IF ADVISED OF THE POSSIBILITY OF SUCH DAMAGE.

## Recycling the product

Your product is designed and manufactured with high quality materials and components, which can be recycled and reused.

When you see the crossed-out wheel bin symbol attached to a product, it means the product is covered by the European Directive 2002/96/EC:



Never dispose of your product with other household waste. Please inform yourself about the local rules on the separate collection of electrical and electronic products. The correct disposal of your old product helps prevent potentially negative consequences on the environment and human health.

### ! Caution

- For products with "non-exchangeable" built-in batteries: The removal of (or the attempt to remove) the battery invalidates the warranty. This procedure is only to be performed at the end of the product's life.

Your product contains a built-in rechargeable battery covered by the European Directive 2006/66/EC, which cannot be disposed of with normal household waste.



To safeguard the functionality and safety of your product, take your product to an official collection point or service center where a professional can remove the battery as shown:

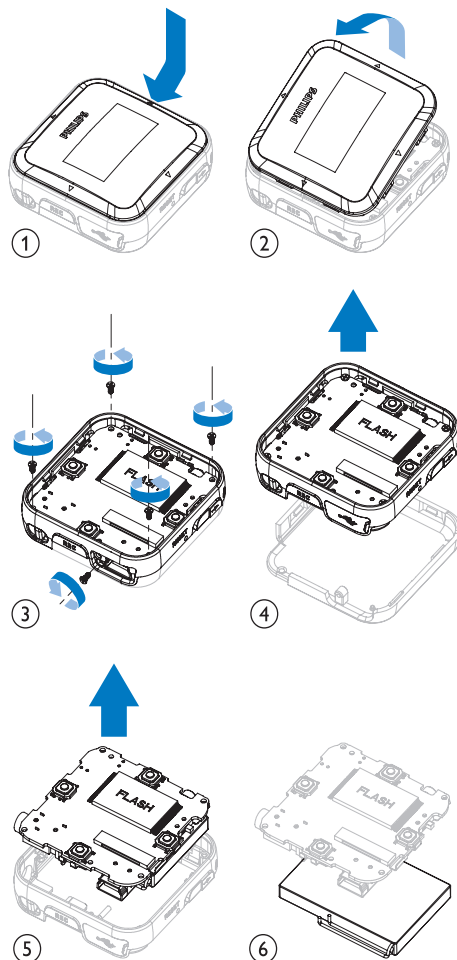

Please inform yourself about the local rules on separate collection of batteries. The correct disposal of batteries helps prevent potentially negative consequences on the environment and human health.

### Notice for the European Union

This product complies with the radio interference requirements of the European Union.

## 2 Your new SA028

SA028 allows you to

- play music
- listen to FM radio
- make voice recordings

---

### What's in the box

Check that you have received the following items:

SA028



Earphones

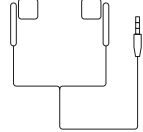

Quick start guide



USB cable



Removable clip

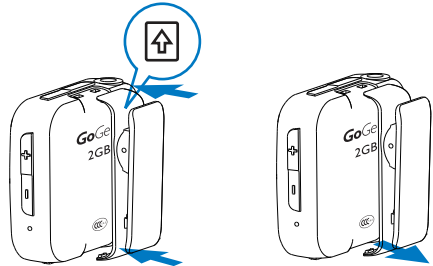

#### Note

- The images serve as reference only. Philips reserves the right to change color/design without notice.

---

### Software loaded on the SA028

SA028 comes with the following software:

- Philips Device Manager (helps you get firmware updates for SA028)

---

### Files loaded on the SA028

The following files are loaded on SA028:

- User manual



# Overview

## Controls and connections

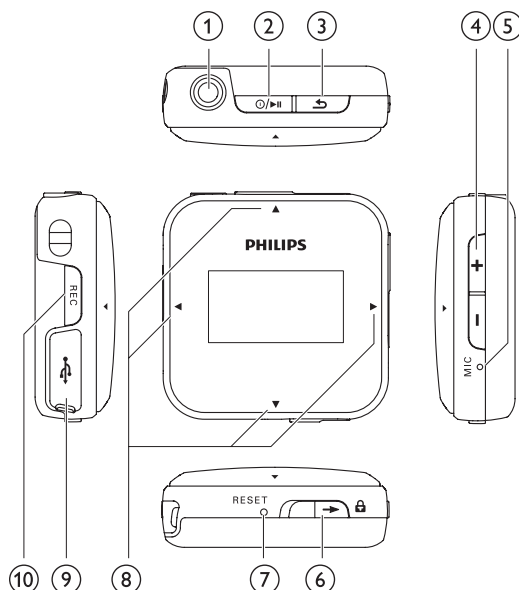

1		3.5mm headphone jack
2		press and hold: turn on/off press: play/pause/resume
3		press: back one level press and hold: return to Home screen
4		press: increase/decrease the volume press and hold: increase/decrease fast
5	<b>MIC</b>	microphone
6		slide: lock/unlock all buttons except <b>VOL +</b>
7	<b>RESET</b>	press the hole by using the tip of a ball pen when the screen does not respond to the pressing of keys

8		navigate through menus
		confirm selection; play/pause/resume
		back one level
		<b>on the list of options</b> press: scroll up/down press and hold: fast scroll through the sorted list of options, initials of current items shown on the screen
		<b>during music play</b> press: skip songs on the play screen press and hold: rewind/fast forward within current song on the play screen
9		USB port for power charging and data transfer
10	<b>REC</b>	press and hold: start recording

# Home screen (main menu)

Menu	Mode	To
🎵	Music	play digital audio tracks
📻	FM radio	listen to FM radio
🎙️	Recording	create or listen to recordings
📁	Folder view	view files in folders
⚙️	Settings	customize the settings of SA028

- From Home screen, you can access desired functional menus by pressing the navigation buttons ▲/▼ and ►.
- To go back to previous screens, press ◀ or ↶ repeatedly; or, press and hold ◀ or ↶ to return to Home screen.

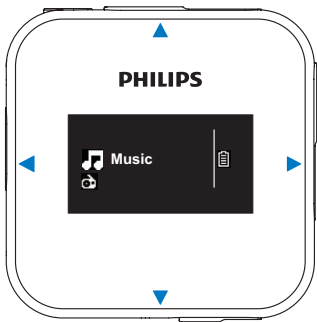
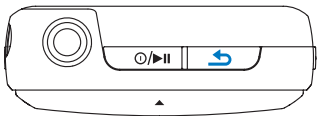

## 3 Getting started

### Connect SA028 to a computer

As shown, connect SA028 to a PC by using a USB cable.

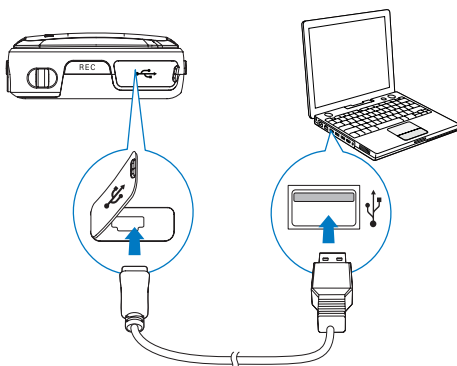

### First-time setup

When you connect the SA028 to the PC for the first time, a pop-up window appears:

- 1 Select **Install Philips Device Manager**.
- 2 Follow the on-screen instructions to complete the installation of the software.

#### Note

- The installation requires you to agree to the license terms.

If the pop-up window is not displayed automatically:

- 1 Select **My Computer** (Windows XP / Windows 2000) / **Computer** (Windows Vista / Windows 7).
- 2 Right click on the **Philips GoGear SA028** icon.
- 3 Select **Install Philips Device Manager**.

- 4 Follow the on-screen instructions to complete the installation of the software.

#### Note

- The installation requires you to agree to the license terms.

### Charge power

SA028 has a built-in battery that can be charged through the USB port of a computer.

### Battery level indication

The display indicates the approximate levels of the battery status as follows:

100%	75%	50%	25%	0%

- ➔ A flashing battery screen indicates that the battery is low. The player saves all settings and switches off within 60 seconds.

#### Note

- Rechargeable batteries have a limited number of charge cycles. Battery life and number of charge cycles vary by use and settings.
- The charging animation stops and the icon is displayed when the charging process is completed.

#### Tip

- You can conserve battery power and increase the play time of SA028 if you ensure that the shortest timer setting is selected. (To check/adjust the timer settings, go to the settings , and then select **[Display Settings] > [Screen off timer]**).

---

## Turn SA028 on and off

Press and hold  until SA028 is turned on or off.

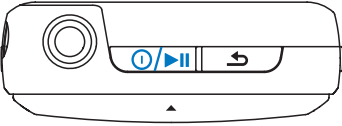

---

## Automatic standby and shut-down

SA028 has an automatic standby and shut-down feature that can save battery power.

After 10 minutes in idle mode (no music plays, no button is pressed), SA028 turns off.

---

## Connect earphones

Connect the supplied earphones to SA028.

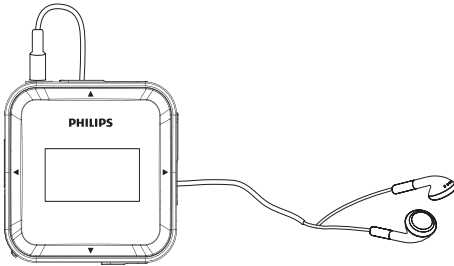

The earphones also work as antennas when you play the FM radio.

---

## Limit the volume



### Caution

- Listening to loud sounds for longer than a moment can be harmful to the listener.

You can set the volume level of SA028 to limit the maximum volume output.

- 1 From the main menu, select **[Settings]** > **[Sound settings]** > **[Volume limit]**.
- 2 Press the **-** / **+** volume controls to adjust the level.
- 3 Press **▶||** to confirm.  
↳ When you set a volume limit, SA028 can no longer exceed the set volume, even if you press the volume **+** button.

To enable maximum volume again:

- 1 Select **[Settings]** > **[Sound settings]** > **[Volume limit]**.
- 2 Set the volume limit to maximum.
- 3 Press **▶||** to confirm.

## 4 Music

### Manage music on PC

#### Organize music files by file information

If the files contain file information (meta tag or ID3 tag), the files can be sorted automatically by Song title, Artist, or Album on **SA028**.

Launch media management software to check or edit the file information. For example, click as shown in **Windows Media Player 11**. Select the desired song, and then, double click it to edit.

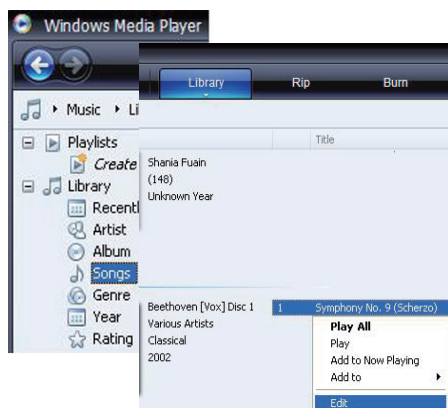

#### Organize music files by file folder

You can also organize music files in different folders as desired.

### Transfer music to SA028

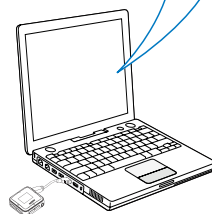
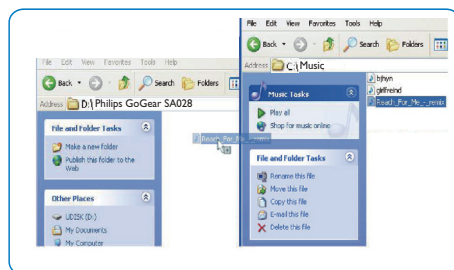

- 1 As shown, connect **SA028** to a PC.
- 2 On the PC, under **My Computer** or **Computer**,
  - Find **SA028**;
  - Find the desired music files/folders.
- 3 From the PC, drag and drop music files/folders to **SA028**.

### Add or delete music files

- 1 Connect **SA028** to a PC.
- 2 On the PC, under **My Computer** or **Computer**,
  - Find **SA028**.
- 3 On the PC, do the following:
  - To add files/folders, drag and drop music files/folders from the PC to **SA028**;
  - To delete files/folders, right click on the selection. Select the delete option as prompted.

## Find your music

From the main menu, select  to enter music mode.

SA028 offers the following menu options:

### [All songs]

- Alphabetically listed tracks

### [Artists]

- Alphabetically listed artists
- Alphabetically listed albums
- Tracks listed in album order

### [Albums]



- Alphanumerically listed albums
- Tracks listed in album order

### Note

- Alternatively, you can select  from the main menu and find your music files in folder view.



## Fast scroll

Start fast scroll on a list of options sorted by number, alphabet, or phonetic character.

- Press and hold ,  to start fast scroll.
  - ↳ On the screen, you can see the initials of current options.



## Play music

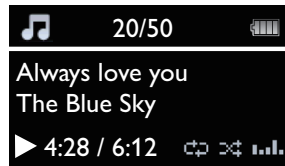

- 1 Select the desired music file.
- 2 If necessary, press  to start play.
  - ↳ Play starts from current song.
  - ↳ On the play screen, you can see the file information and play status.
- 3 During playback,
  - Press  to pause and resume playback.
  - To go to the previous screen, press  on the screen.
    - ↳ Play screen returns a few seconds later.



To select a music file on the play screen

- Repeatedly press  and .

To rewind or fast forward within current song

- On the play screen, press and hold  and .

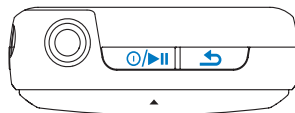

## 5 FM radio





### Note

- Always plug in the supplied earphones when you tune to radio stations. The earphones double as antenna. For better reception, move the earphone cable in different directions.

## Tune to radio stations

### Auto tune

The first time you tune to the radio, start Auto tune to search for available stations.





- 1 From Home screen, go to  > **[Auto tune]**.  
↳ Up to 20 available stations are stored as presets.
- 2 Press / repeatedly to select a preset station. Press  to start play.

### Tip

- When moving to a new place (e.g. a new city or country), restart auto tune for better reception.





### Manual tune

Use Manual tune to tune to a desired frequency or station.







- 1 From Home screen, go to  > **[Manual tune]**.  
↳ The last played station starts to play.
- 2 Press and hold  or .  
↳ You tune to the next available station from current frequency.  
↳ For fine tuning, press  or  repeatedly.

## Store preset stations

On **SA028**, you can store up to 20 preset stations.

- 1 Tune to a desired radio station.
- 2 Press  to store current station as a preset.
- 3 Press ,  to select a location. Press .  
↳ Current station is saved to the location as a preset.

## Listen to FM radio

- 1 From Home screen, go to  > **[Presets]**.
- 2 Press ,  to select a preset station. Press  to start play.
  - Press  to select another preset station from **[Presets]**. Press  to start play.
- 3 If necessary, tune to your desired radio stations (see 'Tune to radio stations' on page 15) .

## 6 Recordings

### Record audio/voices

- 1 Press and hold **REC**.  
↳ Recording screen appears.
- 2 Ensure that the microphone is close to the sound source to be recorded.

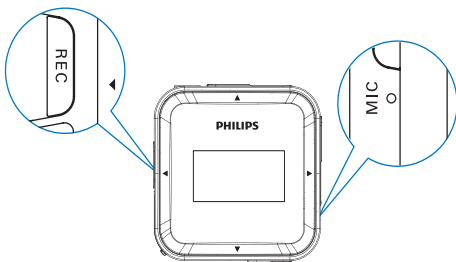

- 3 Press **▶||** to toggle between pause and record. Press **↶** to stop.
- 4 Press **▶||** to save the recording or press **↶** to cancel.  
↳ Recordings are saved on the player:  
(Filename format: VOICEXXX.WAV,  
where XXX is the recording number  
that is generated automatically.)

### Listen to recordings

Listen to voice/audio recordings:

- 1 From the  menu select a recording.
- 2 Press **▶||** to play your recording.

### Delete one or more recordings

This is how to delete recordings in Windows Explorer:

- 1 Connect SA028 to the computer.
- 2 In Windows Explorer, locate the folder **Recordings**.
- 3 Delete the recordings as you normally would on the computer.

### Upload your recordings to a computer

- 1 Connect SA028 to the computer.
- 2 In Windows Explorer, open SA028.
- 3 Select the folder **Recordings**.
- 4 Copy and paste the recordings to any location on the computer.









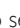

## 7 Settings



This is how you customize SA028:

From Home screen, select  to enter the settings mode.

In the settings menu, navigate as follows:

- 1 Press  /  to select an option.
- 2 Press  to confirm selection.
  - Press   to return to the previous level.
  - Press and hold   to exit the  menu.

### Play mode

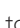



- 1 From Home screen, go to  > [Play mode].
- 2 Press  ,  , and  to select the desired option:



<b>[Repeat]</b>	
<b>[Repeat 1]</b>	repeats current song.
<b>[Repeat all]</b>	repeats all songs in current folder.
<b>[Shuffle]</b>	
<b>[Shuffle all]</b>	plays all songs in current folder in random order.

If both **[Repeat all]** and **[Shuffle all]** are activated,

- All songs in current folder are repeated in random order.

### Sound settings

- 1 From Home screen, select  > [Sound settings].
- 2 Press  ,  , and  to select the desired option:

<b>[FullSound]</b>	Restores the sonic details that music compression loses (e.g. MP3, WMA).
<b>[Equalizer]</b>	Defines sound settings as desired.
<b>[Volume limit]</b>	Sets a maximum volume level for the device. In this way, you can always keep the volume within a level safe enough to your hearing.
	Press  /  to set the volume limit; Press  to confirm.

#### Note

- Equalizer is deactivated when you select FullSound.

## Display settings

### Screen off timer

The screen enters the idle mode, if no new action is taken on **SA028**. After the pre-defined time duration, the idle screen is turned off automatically. To save battery power, select a low value for the time duration.

#### To set the time duration

- 1 From Home screen, select  > [Display settings] > [Screen off timer].
- 2 Select a time duration.
  - ↳ After the selected time duration, the idle screen is turned off automatically.

#### Tip

- For power-saving purpose, always select a low value.

#### To exit the power-saving mode

- Press any key.

## Screensaver

The screen enters the idle mode, if no new action is taken on **SA028**. If you have selected a screensaver, the screensaver appears on the idle screen after the pre-defined time duration.

### To select a screensaver

- 1 From Home screen, select **\* > [Display settings] > [Screensaver]**.
- 2 In **[Screensaver]**, press **▲/▼** and **▶** to select an option:

<b>[Blank screen]</b>	shows blank screen.
<b>[Song title]</b>	shows the title of the song being played.

### To exit the screensaver

- Press any key.

## Language

You can change the language selection.

- 1 From Home screen, go to **\* > [Language]**.
- 2 Press **▲, ▼**, and **▶** to select the desired language.

## Information

From Home screen, go to **\* > [Information]**. You can learn the following information about the device:

<b>[Capacity:]</b>	memory size
<b>[Free space:]</b>	space available
<b>[Firmware version:]</b>	current firmware version. Always check the firmware version when updating firmware from the support website.
<b>[Model:]</b>	full product name. Always check the full product name when updating firmware from the support website.
<b>[Support site:]</b>	web site that provides support for the device

## Restore factory settings

You can restore **SA028** to factory settings.

- 1 From Home screen, go to **\* > [Factory settings]**.
- 2 As prompted, press **▲, ▼**, and **▶||** to restore factory settings.
  - ↳ All settings on **SA028** are restored to factory settings.
  - ↳ Files transferred to **SA028** are retained.

## 8 Update SA028

SA028 is controlled by an internal program called firmware. Newer versions of the firmware may have been released after you have purchased SA028.

The software program called **Philips Device Manager** can use your computer to check for firmware updates that are available on the Internet.

Install **Philips Device Manager** on your computer from SA028 or download the latest version from [www.philips.com/support](http://www.philips.com/support).

### Note

- Your music files are not affected by a firmware update.

## Manually verify / update firmware

- 1 Ensure that your computer is connected to the Internet.
- 2 Connect SA028 to the computer.
- 3 On your computer, click **Start > Programs > Philips > Philips MP3 player > GoGear SA02820X Device Manager** to launch the **Philips Device Manager** to launch **Philips Device Manager**.
- 4 Click **Update**  
↳ **Philips SA02820X Device Manager** checks for updates and installs new firmware from the Internet, if available.
- 5 When the display shows **Update completed**, click **OK**.
- 6 Disconnect SA028 from the computer.  
↳ SA028 restarts after the firmware is updated and is ready for use again.

## 9 Troubleshooting

If SA028 is not working properly or the display freezes, you can reset it without losing data:

### How do I reset SA028?

- Insert a pen tip or other object into the reset hole located at the bottom of SA028. Hold until the player shuts down.
- If the reset option is unsuccessful, follow the steps how to recover SA028 with the **Philips Device Manager**:

- 1 On your computer, select **Start > Programs > Philips > Philips MP3 player > GoGear SA02820X Device Manager** to launch the **Philips Device Manager**.
- 2 Turn off SA028 before you continue.
- 3 Press and hold the volume button **+** while you connect SA028 to your computer.
- 4 Keep holding the key until the **Philips Device Manager** acknowledges SA028 and enters the recovery mode.
- 5 On the computer, click the **Repair** button and follow the instructions of the **Philips Device Manager** to complete the recovery process.
- 6 When the recovery is completed, disconnect SA028 from your computer.
- 7 Restart SA028.

# 10 Technical data

## Power

Power supply: 270 mAh Li-ion polymer internal rechargeable battery

Play time<sup>1</sup>: 20 hours

## Software

Philips Device Manager

## Connectivity

Headphone 3.5 mm

USB 2.0 High speed

## Sound

Channel separation: 40 dB

Frequency Response: 40 - 18,000 Hz

Output power: 7 mW

Signal to noise ratio: > 80 dB

## Audio playback

Supported formats:

Bit rates	Sampling rates
-----------	----------------

MP3:

8 - 320 kbps in CBR and VBR	8, 11.025, 16, 22.050, 24, 32, 44.1, 48 kHz
-----------------------------	---

WMA:

10 - 320 kbps in CBR	8, 11.025, 16,
32 - 192 kbps in VBR	22.050, 32, 44.1, 48 kHz

FLAC:

up to 1.1 Mbps	44.1 kHz
----------------	----------

APE:

up to 1.3 Mbps	48 KHz
----------------	--------

## Music transfer<sup>3</sup>

Drag and drop in Windows® Explorer

## Storage media

Built-in memory capacity<sup>2</sup>:

SA028202X 2GB NAND Flash

## Display

White backlight OLED, 128 x 64 pixels



### Note

- <sup>1</sup> Rechargeable batteries have a limited number of charge cycles. Battery life and number of charge cycles vary by use and settings.
- <sup>2</sup> 1GB = 1 billion bytes; available storage capacity is less. Full memory capacity may not be available as some memory is reserved for the player. Storage capacity is based on 4 minutes per song and 128 kbps MP3 encoding.
- <sup>3</sup> Transfer speed depends on operating system and software configuration.

## System requirements

- Windows® XP (SP3 or above) / Vista / 7
- Pentium III 800 MHz processor or higher
- 512 MB RAM
- 500 MB hard disk space
- Internet connection
- Windows® Internet Explorer 6.0 or later
- USB port

